

Arutanga Harbour Channel Dredging 2020-2022

- The proposal is to dredge the harbour channel (see yellow dashed line) to enable safe passage for the CIPA barge, inter-island cargo vessels, small-medium yachts, and cruise ship lighters.
- Channel dimensions to be dredged =
15 metre width x 5 metres draft (Heron 2012 survey Area A and part Area B only).
Volume of material to be dredged = approximately 70,000m³.
Temporary causeway to be constructed measuring 6 metres wide, along full length of channel, for loading and removal of dredged material.
Causeway to be removed on completion.
- Approximately 8 months to complete dredging works, commencing July/ August 2021.
- Engineering report being prepared for NES review.
- Proposal is to use dredged material as fill for inland roads as requested by the Aitutaki Island Council, and other Island Government projects
- 50T excavator with extra long boom purchased; ETA May 2021. Supplier to assemble and train operators in Aitutaki upon arrival.
- Additional machinery and operators from Aitutaki Island Government and Private Sector to be utilised.
- Consultation with local community and Aitutaki Island Council to take place in from March to June 2021.
- Project Coordination (AIG/AIC, ICI, CIIC, CIPA), delivery approach, cost estimates, management plans, and other arrangements to be finalised in June/July 2021.

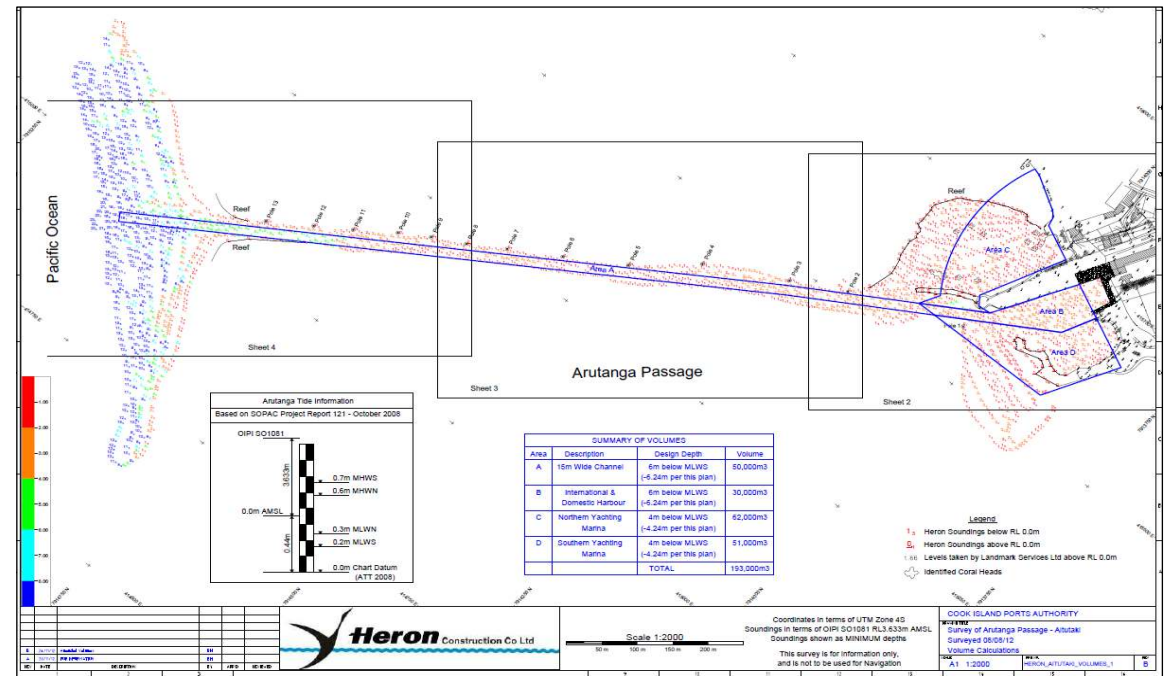

Doosan DX480LC

Excavator purchased in August 2020

ETA Aitutaki: March 2021

Funded by CIG-CAPEX budget

General specifications:

- Make/Model: Doosan DX480LC
- Engine model: Doosan DV11
- Engine RPM: 1800
- Gross vehicle mass: 49Ton
- Engine capacity: 245 KW
- Condition: NEW

Implements:

- Heavy Duty Long-reach boom
- Hydraulic Drum Cutter Head (up to 80MPa)
- Hydraulic Quick Coupler
- Standard sand bucket
- Rock bucket with claws
- Static single point ripper

